

# LEONARDS

SINCE 1884

Estate Agents  
Lettings & Management  
Chartered Surveyors  
Valuers & Auctioneers  
Land & Rural Consultants



## 4 Astral Gardens, Hull, East Yorkshire, HU7 4YS

- Three Bedroom Mid Terrace House
- Priced to Allow for Improvements
- Entrance Hall with Stairs Off
- Kitchen
- Small Garden Areas with Parking Area
- Offered For Sale with No Forward Chain
- Located off Wawne Road and Astral Way
- Lounge Diner
- Three Bedrooms and Bathroom
- Early Viewing Advised

**Offers In The Region Of £110,000**



512 Holderness Rd, Hull, East Yorkshire HU9 3DS

Tel: 01482 375212

E-mail: [info@leonards-property.co.uk](mailto:info@leonards-property.co.uk)

Website: [www.leonards-property.co.uk](http://www.leonards-property.co.uk)

59 Welton Road, Brough, East Yorkshire HU15 1AB

Tel: 01482 330777

E-mail: [brough@leonards-property.co.uk](mailto:brough@leonards-property.co.uk)





# 4 Astral Gardens, Hull, East Yorkshire, HU7 4YS

Three bedroom mid terrace house, offered for sale with No Forward Chain. The property requires a scheme of improvements and is therefore priced to sell. Located off Wawne Road and Astral Way. The accommodation comprises:- Entrance with stairs off, lounge diner, kitchen, first floor landing, three bedrooms and bathroom. Small garden areas with off set parking area. Gas fired central heating system (not tested) and double glazing. Viewing via Leonards.

## Location

The village of Sutton lies just inside Kingston Upon Hull boundary, approximately three and a half miles north East of the City Centre. The village has a few local shops and amenities. There are local primary and secondary schools nearby and the village offers good road access via the outer ring road to the Ennerdale link road to areas such as Beverley and York and via Hedon Road to the A63.

## Entrance Hall

Main front entrance door provides access into the property. Stairs lead off to the first floor accommodation with under stairs cupboard. Radiator. Access into ground floor rooms off.

## Lounge Diner

11'9" x 13'6" + 8'4" x 10'4" (3.583m x 4.122m + 2.562m x 3.152m)  
Window to the front elevation and door to the rear. Two radiators.

## Kitchen

8'11" x 9'9" max (2.739m x 2.996m max)  
Containing a range of base and wall units, work surfaces with sink unit. Space for appliances. Window to the rear elevation with rear entrance door.

## First Floor Landing

Access to roof void. Cupboard. Doors to all rooms off.

## Bedroom One

10'2" x 12'4" (3.110m x 3.769m)  
Window to the front elevation and radiator.

## Bedroom Two

9'11" x 11'3" (3.028m x 3.439m)  
Window to the rear elevation and radiator. Boiler cupboard with gas fired central heating boiler.

## Bedroom Three

7'5" x 9'4" max (2.265m x 2.864m max)  
Window to the front elevation and radiator. Cupboard over the stairs.

## Bathroom

7'7" x 5'5" (2.333m x 1.669m)  
Suite of bath with shower over, wash hand basin and WC. Window to the rear elevation. Radiator.

## Outside

Small garden areas to the front and rear.

## Parking

There is an off set parking area from the property.

## Energy Performance Certificate

The current energy rating on the property is C (73).



### Mortgage Advice

UK Moneyman Limited is now Leonards preferred partner to offer independent mortgage advice for the purchase of this or any other residential property. As a reputable Licensed credit broker, UK Moneyman will carry out a comprehensive search of a wide range of mortgage offers tailored to suit your particular circumstances, with the aim of saving you both time and money. Customers will receive a free mortgage appointment with a qualified Advisor. Written quotations on request. Call us today on 01482 375212 or visit our website to arrange your free, no obligation mortgage appointment. We may receive a fee if you use UK Moneyman Limited's services. Your home is at risk if you do not keep up repayments on a mortgage or other loan secured on it.

### Purchaser Outgoings

From internet enquiries with the Valuation Office website the property has been placed in Band A for Council Tax purposes. Local Authority Reference Number 00230407000409. Prospective buyers should check this information before making any commitment to take up a purchase of the property.

### Referral Fees

As part of our service, we often recommend buyers and sellers to our local conveyancing providers, namely Jane Brooks Law, Graham & Rosen and Brewer Wallace whereby we will obtain from them on your behalf a quotation. It is at your discretion whether you choose to engage the services of the provider that we recommend. Should you do so, you should know that we would expect to receive from them a referral fee of £104.17 + VAT (£125.00 including VAT) from Jane Brooks Law or £104.17 + VAT (£125 including VAT) from Graham & Rosen or £100.00 +VAT (£120.00 including VAT) from Brewer Wallace for each successful completion transaction for recommending you to them. We will also have a mortgage referral arrangement with Hull Moneyman for which we will receive a fee based on the procuration fee they receive.

### Services

The mains services of water, gas and electric are connected. None of the services or appliances including boilers, fires and any room heaters have been tested.

For mobile/broadband coverage, prospective occupants are advised to check the Ofcom website:- <https://checker.ofcom.org.uk/en-gb/mobile-coverage>

### Tenure

The tenure of this property is Freehold.

### Viewings

Strictly through the sole agents Leonards 01482 375212/01482 330777

### Free Sales Market Appraisal/Valuation

Thinking of selling your house, or presently on the market and not yet achieved a sale or the level of interest you expected\*? Then why not contact Leonards for a free independent market appraisal for the sale of your property? We have many years of experience and a proven track record in the selling of properties throughout the city of Hull and the East Riding of Yorkshire. \*Where your property is presently being marketed by another agent, please check you agency agreement for any early termination costs or charges which may apply.



**Ground Floor**

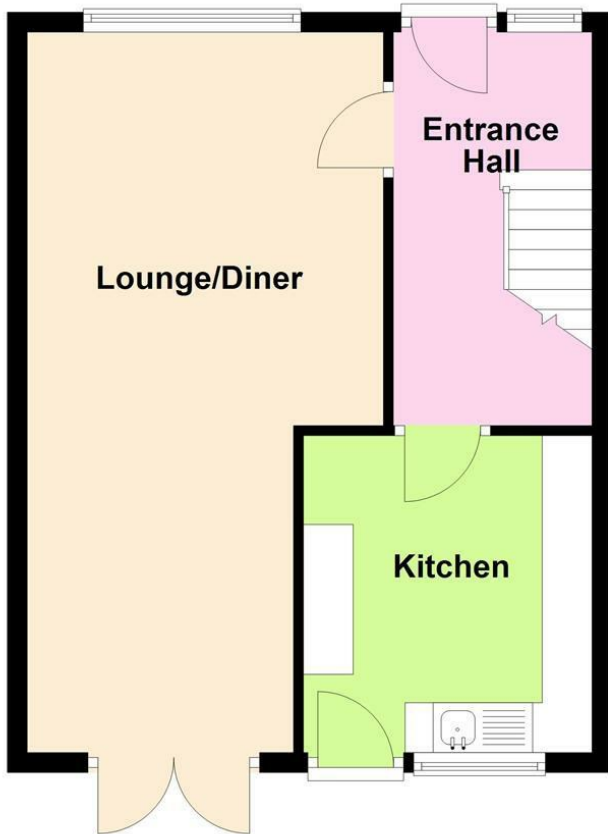

**First Floor**

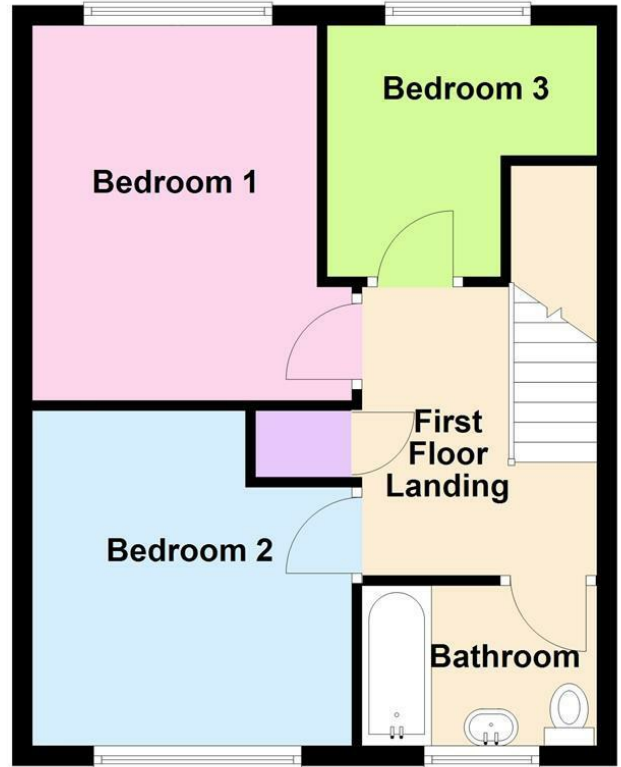

## 4 Astral Gardens, Hull

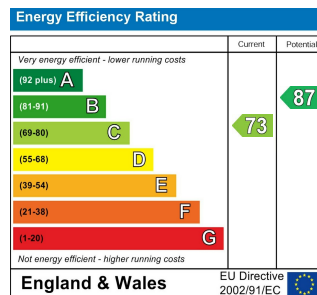

Money Laundering Regulations 2003 & Immigration Act 2014: Intending purchasers will be asked to produce identification documentation at a later stage. 2. General: While we endeavour to make our sales particulars fair, accurate and reliable, they are only a general guide to the property and accordingly if there is any point which is of particular importance, please contact our office and we will endeavour to check the position for you. 3. Measurements: These approximate room sizes or any stated areas are only intended as general guidance. You must verify the dimensions carefully before ordering carpets or any built-in furniture etc. 4. Services: Please note we have not tested the services or any of the equipment or appliances in this property, accordingly we strongly advise prospective buyers to commission their own survey or service reports before finalising their offer to purchase. 5. Photographs & Floor Plans: Floor plans where supplied, are not to scale and are provided for general reference only, photographs may have been taken using a wide angle lens which also has the potential to make a room look larger and therefore please refer to the room measurements detailed within this brochure. 6. Leonards for themselves and their vendors of this property, whose agents they are given notice that these particulars are issued in good faith but do not constitute representations of fact or form part of any offer or contract. Matters referred to should be independently verified by any prospective purchaser. Neither Leonards, nor any of its employees or agents has any authority to make or give any representation or warranty in relation to this property. You may download, store and use the material for your own personal use and research. You may not republish, retransmit, redistribute or otherwise make the material available to any party or make the same available on any website.